

DO NOT EXCEED

Maximum Working Pressure: 1000 PSI

Maximum Temperature: 300°F

OPERATION & PARTS MANUAL

7, 17 & 33 GALLON TANKS

- **EASY TO REMOVE CAP**
 - **NO MOVING PARTS**
- **NO PUMPS**
 - **NO WIRING**
- **VENTURI STYLE**
 - **INFINITE FLOW CONTROL WITH NEEDLE VALVE**

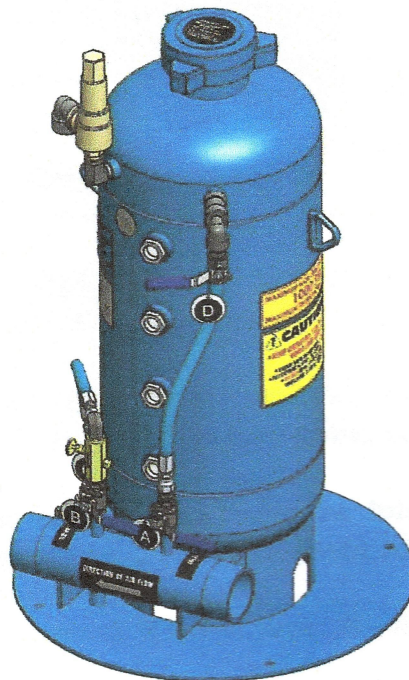

- **MANIFOLD CAN BE REMOVED FROM TANK AND MOUNTED REMOTELY**
 - **(4) SIGHT GLASSES**
- **PRESSURE VESSEL (ASME CODE STAMPED)**
 - **2", 3" & 4" MANIFOLDS**
- **FILL WHILE YOU DRILL**
 - **FITS ANY DRILL RIG**

24 HOURS A DAY
7 DAYS A WEEK

Any questions regarding operation, safety or capabilities of this lubricator should be directed to:

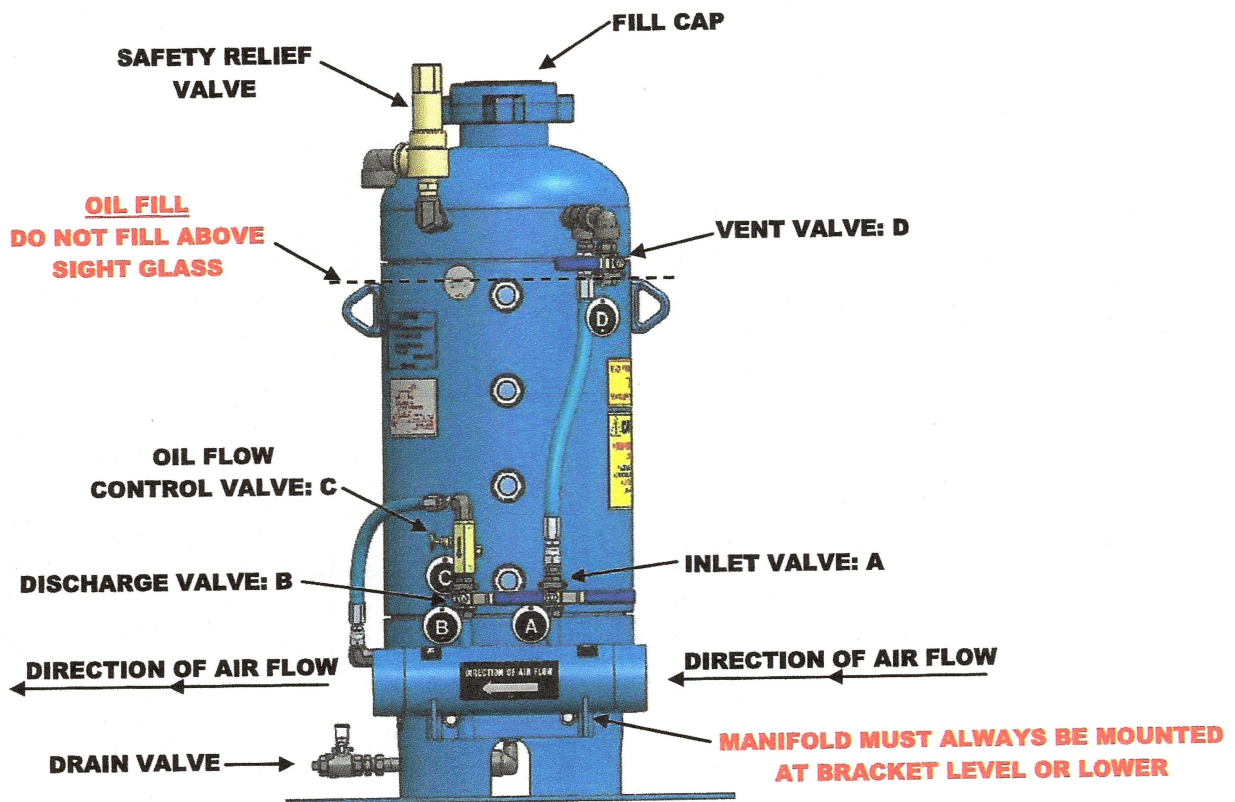

OPERATING INSTRUCTIONS

- 1) Lubricator must be installed upstream of any other injected fluids such as mud, foam and water.
- 2) Connect air supply to inlet side of manifold, install whipcheck
- 3) Connect outlet side of manifold to line going to hammer, install whipcheck
- 4) Close vent valve: D
- 5) Apply air pressure to manifold and open air inlet valve: A
- 6) Open oil flow control valve: C four complete turns and lock in place
- 7) Open discharge valve: B
- 8) Operate hammer and check if bit is wet. A properly lubricated tool will be wet but not dripping oil
- 9) To control lubricating, adjust oil flow control valve: C counter-clockwise to increase oil, clockwise to decrease. With correct adjustment, tighten nut and continue drilling
- 10) To stop oiler, close air inlet valve: A and close discharge valve: B

FILLING INSTRUCTIONS

- 1) Close inlet valve: A
- 2) Close discharge valve: B
- 3) Open vent valve: D
- 4) After all air has bled out of tank, remove fill cap
- 5) Fill lubricator tank with rock drill oil. Do not overfill.
- 6) Replace fill cap. Make sure o-ring is in place.
- 7) Close vent valve: D
- 8) Open inlet valve: A
- 9) Open discharge valve: B

SIZE	BASE DIAMETER	DIAMETER AT MANIFOLD	HEIGHT	WEIGHT (LBS)
7 GAL	19"	25"	33"	160
17 GAL	23"	29-3/8"	40"	375
33 GAL	23"	35"	39"	675

CLOSURE O-RING
PART #622248

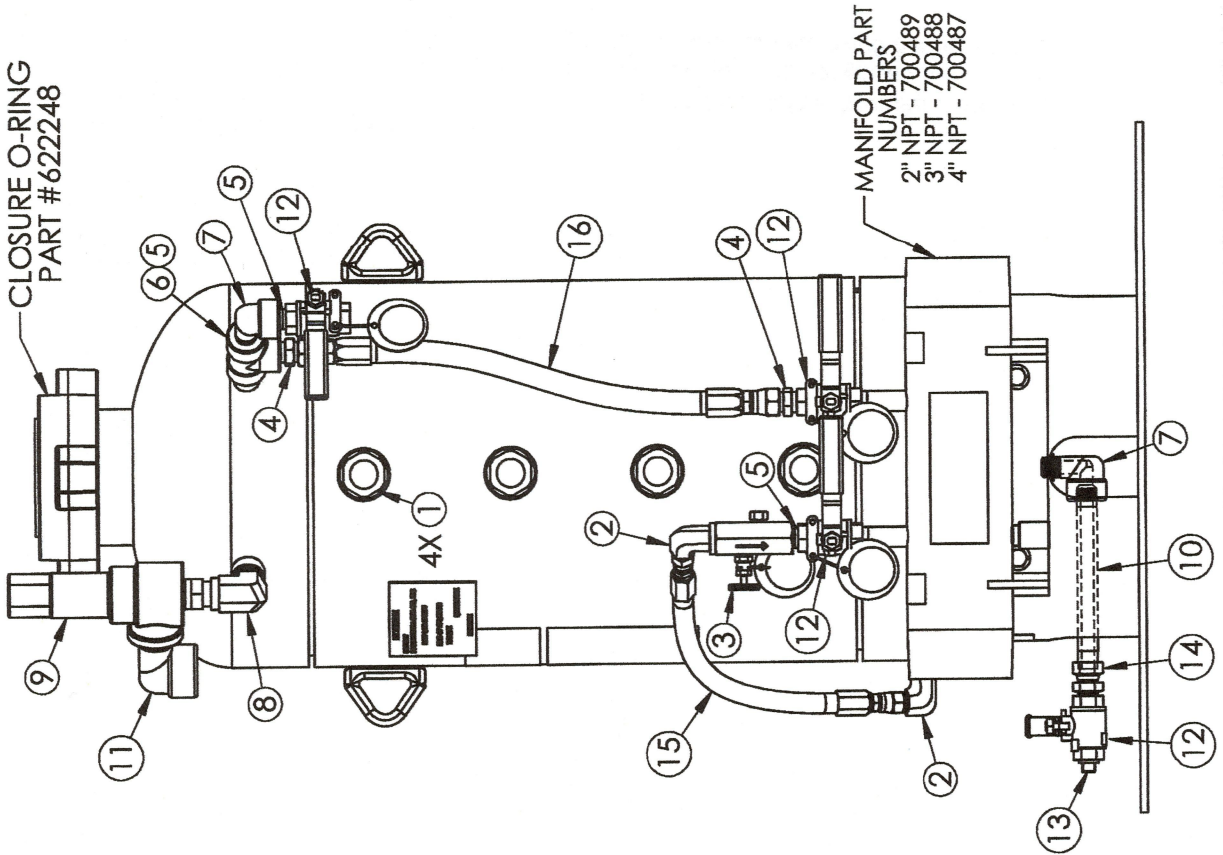

ITEM NO.	QTY.	PART NUMBER	DESCRIPTION
1	4	621702	GAUGE, SIGHT GLASS
2	2	602830	FITTING, 90° ADAPTER
3	1	621600	VALVE, NEEDLE
4	2	603031	FITTING, ADAPTER
5	3	607147	FITTING, NIPPLE
6	1	607202	FITTING, TEE
7	2	607021	FITTING, 90° ST ELL
8	1	621837	FITTING, 90° ADAPTER
9	1	623183	VALVE, SAFETY RELIEF
10	1	*SEE NOTE	FITTING, NIPPLE
11	1	607018	FITTING, 90° ST ELL
12	4	621599	VALVE, BALL
13	1	607164	FITTING, SQ HEAD PLUG
14	1	621836	FITTING, ADAPTER
15	1	*SEE NOTE	HOSE ASSY, #6, DISCHARGE
16	1	*SEE NOTE	HOSE ASSY, #8, INLET

GENERAL NOTES:

- (1) PART NUMBERS FOR ITEMS (10), (15) & (16) ARE SPECIFIC TO THE TANK SIZE. PLEASE CALL TO ORDER THESE PARTS.
- (2) DECALS AVAILABLE UPON REQUEST
- (3) COMPLETE LUBRICATOR ASSEMBLIES:
7 GALLON - 701282
17 GALLON - 700282
33 GALLON - 700284

TITLE:

**PARTS LIST, LUBRICATOR,
7-17-33 GALLON**

SIZE DWG. NO. REV

B KD000338 00

NAME DATE
C.A.B. 01/31/17

A.C.H. 03/02/17

DRAWN CHECKED

3

4

5

2

1

SCALE: 1:6 WEIGHT: N/A SHEET 1 OF 1

LUBRICATOR SAFETY

- Ensure that the operator, maintenance/service and all relevant personnel read, understand and follow all information that is provided in all manuals before operating, servicing and/or maintaining the lubricator.
 - Ensure that operator and maintenance personnel are competent and have been adequately trained.
 - Never operate the lubricator without first observing all safety warnings and decals. Operators, maintenance/service and all relevant personnel must understand all decals and safety warnings.
 - Do not paint over safety warnings or instructional decals. If safety warning decals become illegible or missing, immediately order replacements from the factory.
 - All federal, state, local and site ordinances, rules and regulations must be followed.
 - High Pressure air can cause serious injury or death. Relieve pressure before removing filler plugs/caps, fittings or covers or performing any maintenance or service work.
 - Do not alter or modify the tank.
 - Do not operate lubricator with safety devices bypassed or disconnected.
 - Disconnected air hoses whip and can cause serious injury or death. Always use approved whip check/cable on hose ends to prevent whipping.
 - Do not operate the lubricator at pressures in excess of its Maximum Allowable Working Pressure (M.A.W.P.) rating as indicated on the ASME data plate. The M.A.W.P. (Maximum Allowable Working Pressure) of the lubricator should be known to all relevant personnel.
 - Avoid bodily contact with compressed air.
 - Keep personnel out of line with and away from the discharge opening of hoses, tools or other points of compressed air discharge.
 - Do not engage in horseplay with air hoses as death or serious injury may result.
 - When replacement parts are required for this lubricator, Keystone recommends using genuine parts from the original manufacturer or parts with equivalent specifications including, but not limited to physical dimensions, type, strength and material. Failure to heed this warning can lead to premature failures, product damage, and/or personal injury or death.
-