

**BB12**

**w/6-5/8" API Reg Pin**

**Wt. 1,225 lbs.**

**EBB12-STD-Hammer**

**TAKES QL120 SHANKS**

\*\*SPECIAL BACKHEAD FEATURES – CALL OFFICE

Thread Change/Pin :  
 Box Thread  
 Carbide Buttons  
 Side Carbide Buttons  
 Special Flats

**Replacement Parts**

Hmr Part #	Description	Order #	Weight (lbs.)	Price
BB12-01	Top Sub 6-5/8" API REG PIN w/O-Ring	<b>EBB12-01</b>	228	
BB12-17	**Replacement O-Ring for Top Sub**	<b>E12-17</b>	0.1	
BB12-02	Piston Case w/Retainer Ring	<b>EBB12-02</b>	509	
BB12-06	**Replacement Retainer Ring for Piston Case**	<b>E12-06</b>	0.4	
BB12-03	Chuck	<b>EBB12-03</b>	100	
BB12-04	Piston	<b>EBB12-04</b>	170	
BB12-05	Make Up Ring	<b>E12-05</b>	0.8	
BB12-07	Check Valve Dart	<b>E12-07</b>	3.0	
BB12-08	Check Valve Dart Spring	<b>E12-08</b>	0.3	
BB12-09	Check Valve Guide	<b>E12-09</b>	30.0	
BB12-10	Rigid Valve w/O-Ring	<b>E12-10</b>	32.0	
BB12-13	**Replacement O-Ring for Rigid Valve**	<b>E12-13</b>	0.1	
BB12-11	Choke Set (4)	<b>E12-11</b>	1.6	
BB12-11A	Blank Choke	<b>E12-11A</b>	0.4	
BB12-11B	1/8" Choke	<b>E12-11B</b>	0.4	
BB12-11C	1/4" Choke	<b>E12-11C</b>	0.4	
BB12-11D	3/8" Choke	<b>E12-11D</b>	0.4	
BB12-12	Bit Retainer Ring w/O-Ring	<b>EBB12-12</b>	12	
BB12-16	**Replacement O-Ring for Bit Retainer Ring**	<b>E12-16</b>	0.1	
BB12-14T	Breakout Ring	<b>EBB12-14T</b>	2	
BB12-14B	Breakout Ring	<b>EBB12-14B</b>	3	
BB12-18	Bearing w/ (2) O-Rings	<b>EBB12-18</b>	0.1	
BB12-15	**Replacement O-Ring for Bearing (uses 2)**	<b>EBB12-15</b>	0.1	
BB12-19	Foot Valve	<b>EQL120-24</b>	1	

Price is subject to change without notice.

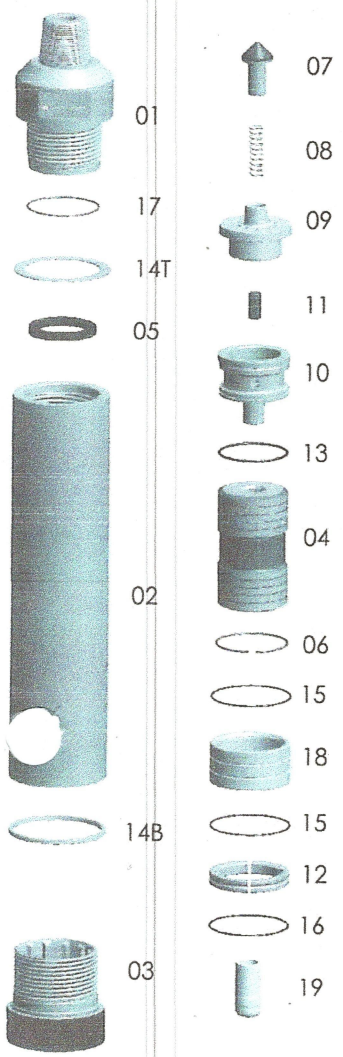

	Outside Diameter		Hammer Length Shoulder To Shoulder				Bit Size Range		
	IN.	MM.	IN.	MM.	IN.	MM.			
BB12	11.2	285	55	1397	11 7/8 – 17 1/2	302 – 445			
<b>Choke Size</b>	<b>100</b>	<b>6.9</b>	<b>150</b>	<b>10.3</b>	<b>200</b>	<b>250</b>			
<b>IN. MM.</b>	<b>PSI</b>	<b>BARS</b>	<b>PSI</b>	<b>BARS</b>	<b>PSI</b>	<b>BARS</b>			
Blank	Blank	850	24.06	1200	33.98	1650	46.72	2000	56.63

The above air charts are based upon ideal conditions, your results may vary.