

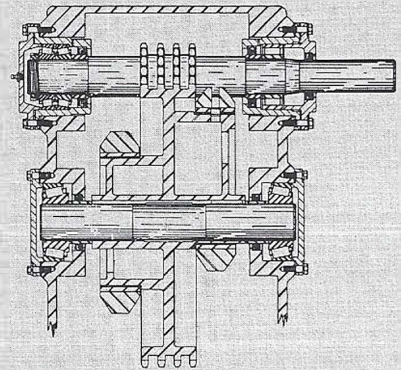

GEORGE E. FAILING CO.

MODEL FM-45

Mudmaster® 5" x 6-1/4" Slush Pump

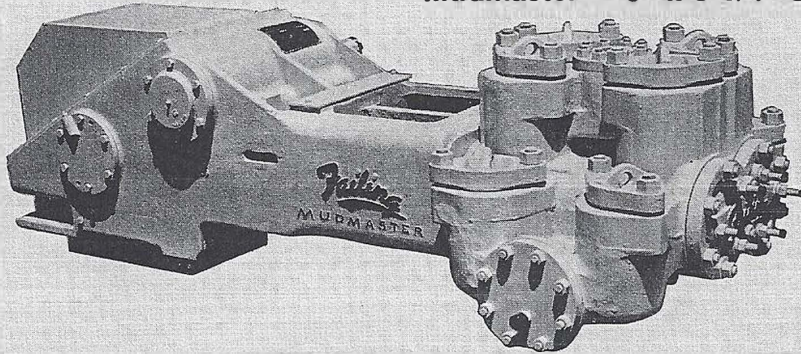

The **Failing** Model FM-45 is a duplex reciprocating type power slush pump designed for maximum volume without sacrifice of working pressure and compactness.

Its power end is a rugged, one-piece unit with integral supports for jackshaft and eccentric shaft bearings. The cover is removable for easy access to the power end mechanism. Main sprocket and eccentrics are cast in one piece and keyed to a straight alloy steel shaft. These shafts are roller bearing mounted and power is transmitted by a high speed quadruple roller chain.

Connecting rods are one-piece steel with renewable eccentric bushings and bronze crosshead bushings. The one-piece skirt type cast alloy crosshead is reinforced at all

load areas.

Fluid end of the FM-45 is a one-piece casting with conventional pot type valves. Steel studs secure valve covers, flanges and plates to the fluid end, and fluid end to power end.

All bearings are sealed in individual pressure gun lubricated housings. Eccentrics, chain, crossheads and pins are lubricated from the power end reservoir through normal movement of parts.

Failing lubricator type packing glands provide positive lubrication to piston rods. This pump is equipped with **Failing Mudmaster®** pistons, hardened liners, rods and valves.

N.D.S. Drilling Supply
 26041 Newton Circle
 Elkton, MN 55020
 Phone # 800-637-1940
 Fax # 952-461-3403

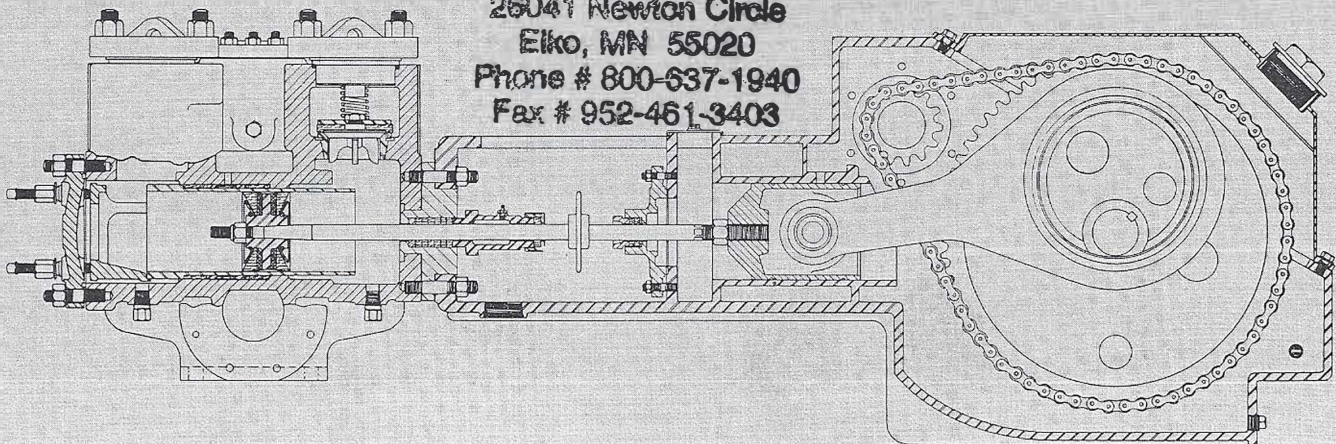

Specifications

Size, Ins.		Max. Pressure (Lbs. Per Sq. In.)	Displacement			R.P.M.			Pipe Size			Approx. O.A. Dim. Ins.		
Dia. of Fluid Cylinder	Length of Stroke		Displacement U.S. Gals. per Min. (Rods Deducted)	Approx. Barrels Per Hr. (42 U.S. Gal.)	Brake H.P. at Max. Pressure	Crank-shaft	Jack-shaft	Max. Plunger Load (Lbs.)	Suction	Dischg.	Approx. Wt. of Pump (Lbs.)	Height	Width of Mud End	Length
Model FM-45 — 900 Pounds Working Pressure — 1800 Pounds Test Pressure														
5		310	104-208	149-297	23-46									
4½		385	84-168	120-240	23-46									
4	6¼	492	66-132	94-188	23-46	50 -100	236-473	6320	4	2	2630	26-9/16	32¼	80-13/16
3½		646	50-100	71-143	23-46									
3		895	36-72	52-103	22.5-45									

Slush Pump Parts

MODEL FM-45 PARTS DRAWINGS

Frame

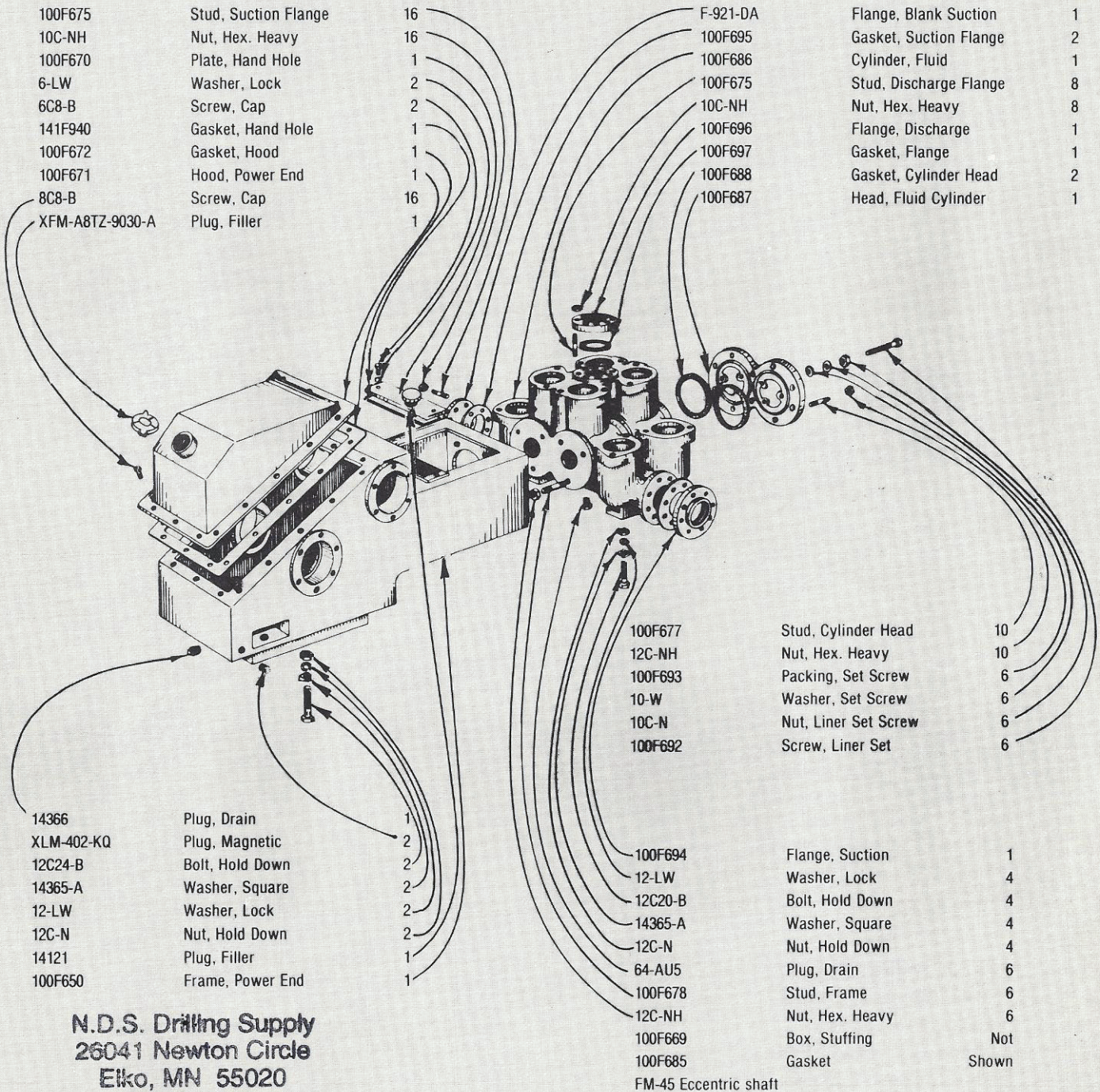

100F675	Stud, Suction Flange	16
10C-NH	Nut, Hex. Heavy	16
100F670	Plate, Hand Hole	1
6-LW	Washer, Lock	2
6C8-B	Screw, Cap	2
141F940	Gasket, Hand Hole	1
100F672	Gasket, Hood	1
100F671	Hood, Power End	1
8C8-B	Screw, Cap	16
XFM-ABTZ-9030-A	Plug, Filler	1

F-921-DA	Flange, Blank Suction	1
100F695	Gasket, Suction Flange	2
100F686	Cylinder, Fluid	1
100F675	Stud, Discharge Flange	8
10C-NH	Nut, Hex. Heavy	8
100F696	Flange, Discharge	1
100F697	Gasket, Flange	1
100F688	Gasket, Cylinder Head	2
100F687	Head, Fluid Cylinder	1

100F677	Stud, Cylinder Head	10
12C-NH	Nut, Hex. Heavy	10
100F693	Packing, Set Screw	6
10-W	Washer, Set Screw	6
10C-N	Nut, Liner Set Screw	6
100F692	Screw, Liner Set	6

14366	Plug, Drain	1
XLM-402-KQ	Plug, Magnetic	2
12C24-B	Bolt, Hold Down	2
14365-A	Washer, Square	2
12-LW	Washer, Lock	2
12C-N	Nut, Hold Down	2
14121	Plug, Filler	1
100F650	Frame, Power End	1

100F694	Flange, Suction	1
12-LW	Washer, Lock	4
12C20-B	Bolt, Hold Down	4
14365-A	Washer, Square	4
12C-N	Nut, Hold Down	4
64-AU5	Plug, Drain	6
100F678	Stud, Frame	6
12C-NH	Nut, Hex. Heavy	6
100F669	Box, Stuffing	Not
100F685	Gasket	Shown

N.D.S. Drilling Supply
 26041 Newton Circle
 Elkco, MN 55020
 Phone # 800-637-1940
 Fax # 952-461-3403

FM-45 Eccentric shaft



GEORGE E. FAILING CO.

MODEL FM-45 PARTS DRAWINGS

Eccentric Shaft

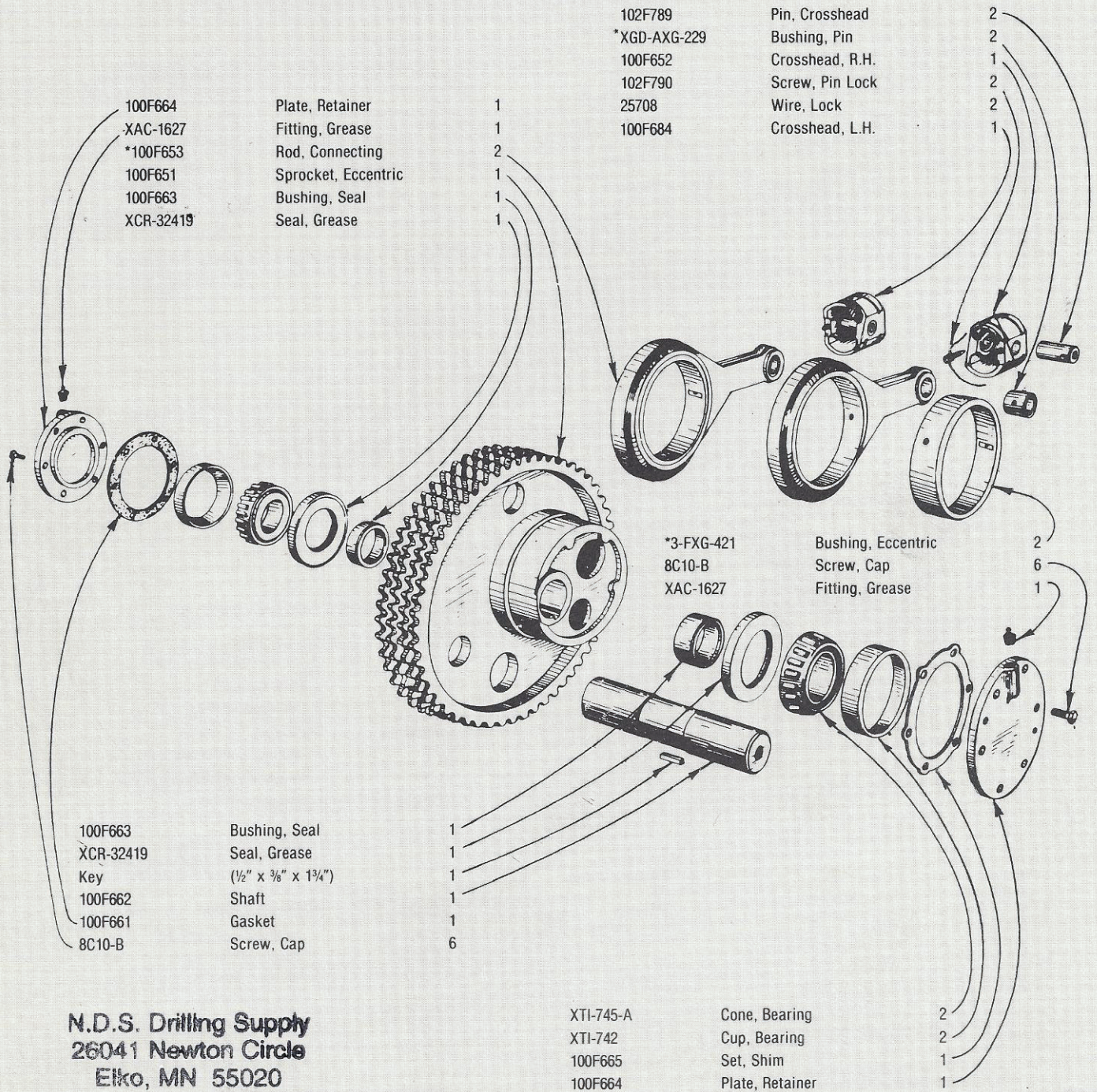

N.D.S. Drilling Supply
 26041 Newton Circle
 Etiko, MN 55020
 Phone # 800-637-1940
 Fax # 952-461-3403

*Part of 146F830 Connecting Rod Assembly

Slush Pump Parts

MODEL FM-45 PARTS DRAWINGS

Jackshaft

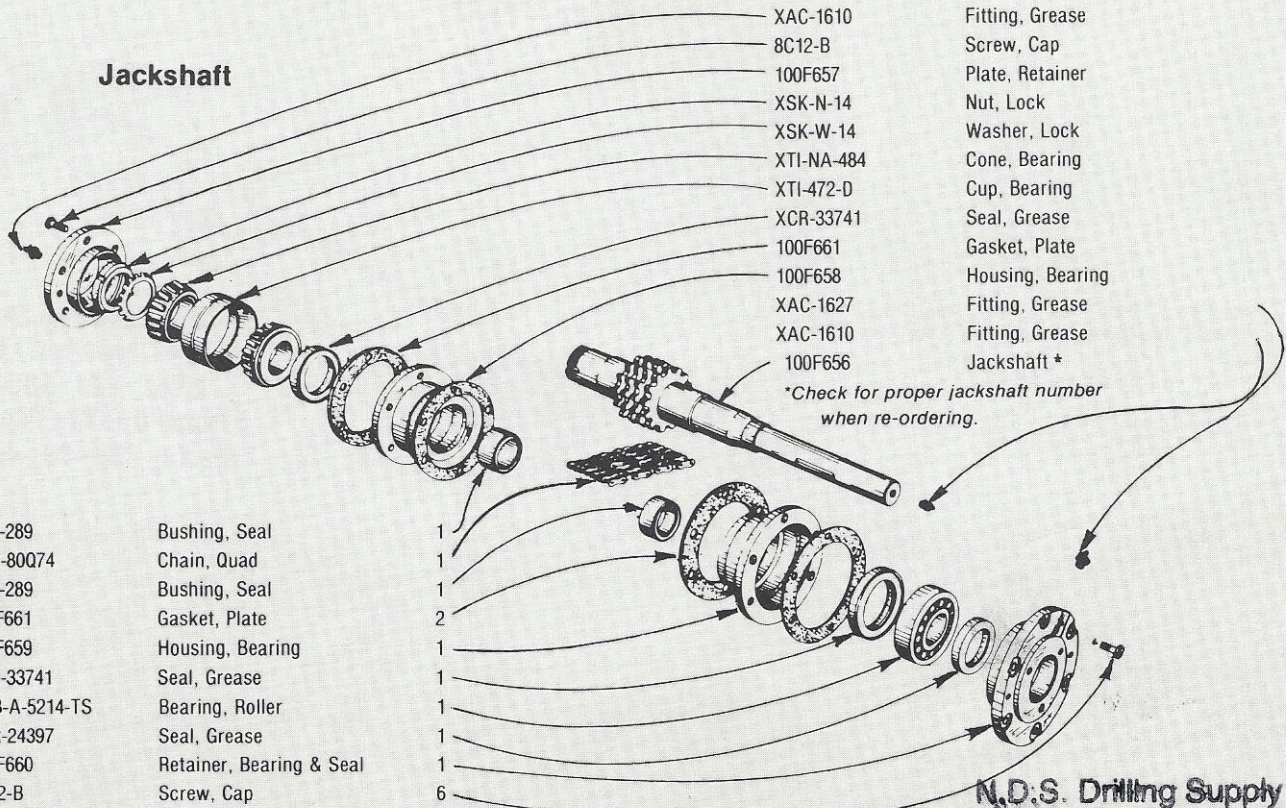

- | | |
|---------------|--------------------------|
| FXG-289 | Bushing, Seal |
| XDC-80Q74 | Chain, Quad |
| FXG-289 | Bushing, Seal |
| 100F661 | Gasket, Plate |
| 100F659 | Housing, Bearing |
| XCR-33741 | Seal, Grease |
| XHB-A-5214-TS | Bearing, Roller |
| XCR-24397 | Seal, Grease |
| 100F660 | Retainer, Bearing & Seal |
| 8C12-B | Screw, Cap |

Stuffing Box

Piston Rod Stuffing Box

- | | |
|--------------|-----------------|
| 100F685 | Gasket |
| 100F669 | Box, Stuffing |
| FG-317 | Ring, Junk |
| XGD-60-A-222 | Ring, Packing |
| FG-21-A | Gland, Packing |
| XAC-1610 | Fitting, Grease |
| XGD-60-A-222 | Ring, Packing |
| 870-F | Nut, Gland |
| 100F676 | Stud |
| 10C-NH | Nut, Stud |

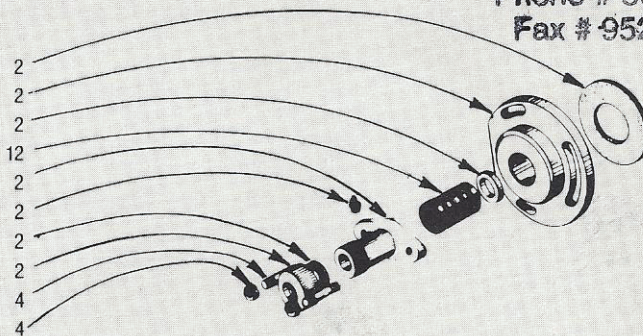

N.D.S. Drilling Supply
 26041 Newton Circle
 Elk, MN 55020
 Phone # 800-637-1940
 Fax # 952-461-3403

Oil Stop Head

- | | | | |
|--|--------------|----------------|---|
| | 8C-N | Nut | 4 |
| | 100F674 | Stud | 4 |
| | 100F667 | Gland, Head | 2 |
| | XGD-60-A-222 | Packing | 4 |
| | AG-318 | Washer | 2 |
| | 8C-N | Nut | 4 |
| | 100F674 | Stud | 4 |
| | 100F666 | Head, Oil Stop | 2 |
| | 100F668 | Gasket | 2 |



MODEL FM-45 PARTS DRAWINGS

Liner, Piston & Rod

- 16C-NH Nut, Rod Lock
- 21-FXG-183 Rod, Piston
- D-1827-A Spacer, Sleeve
- *D-1826 Sleeve, Liner
- D-1825 Liner, Pump
- 100F691 Clamp, Liner

*Interchangeable width XGD-25-T-27 and XGD-1-FXG-445 as an assembly. Individual parts are not interchangeable.

Note: One kit required per piston.

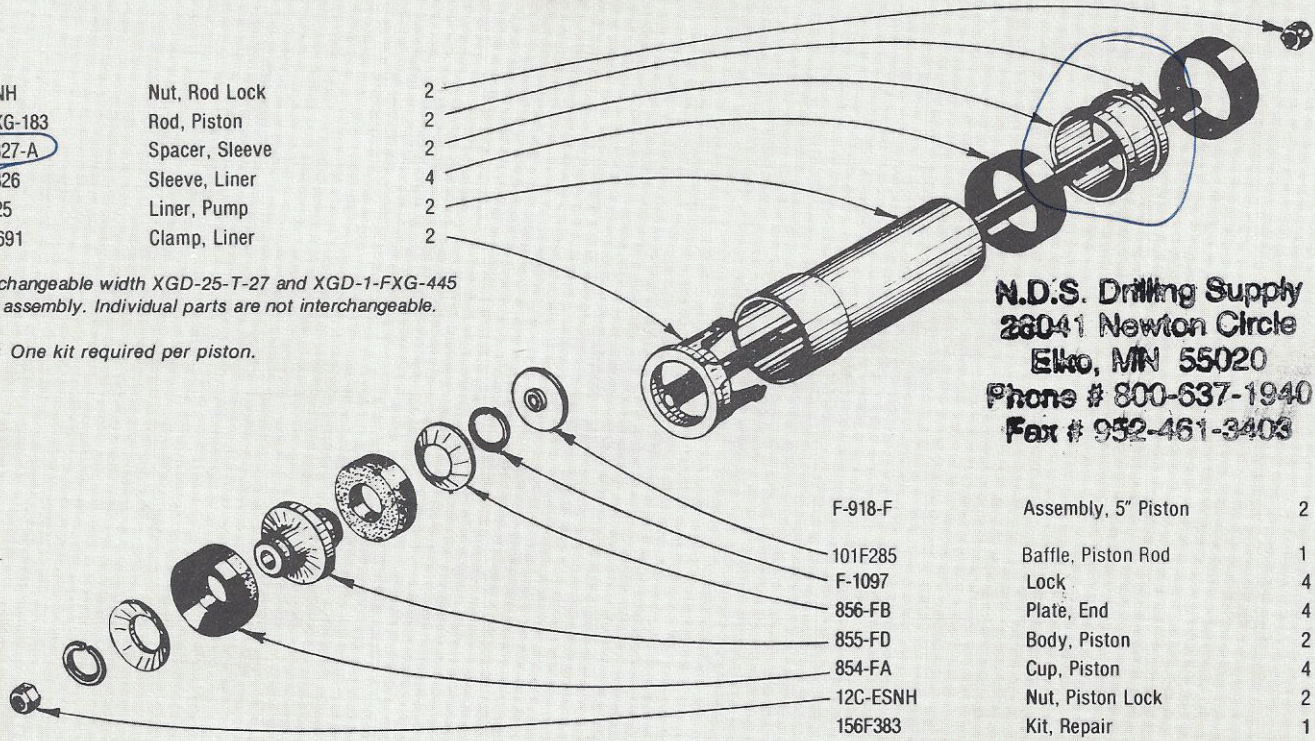

N.D.S. Drilling Supply
 28041 Newton Circle
 Elkton, MN 55020
 Phone # 800-637-1940
 Fax # 952-461-3403

- F-918-F Assembly, 5" Piston 2
- 101F285 Baffle, Piston Rod 1
- F-1097 Lock 4
- 856-FB Plate, End 4
- 855-FD Body, Piston 2
- 854-FA Cup, Piston 4
- 12C-ESNH Nut, Piston Lock 2
- 156F383 Kit, Repair 1

Valve Assemblies

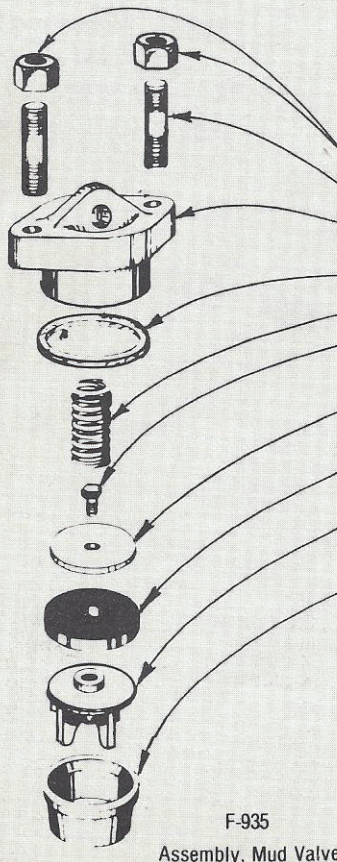

F-935
 Assembly, Mud Valve

- 16C-NH Nut, Stud
- 100F679 Stud, Cover
- 100F689 Plate, Cover
- 100F690 Gasket
- XGD-78-A-171 Spring, Valve
- 10C8-ESB Bolt
- 101F865 Bolt
- F-929 Washer, Valve
- 101F863 Washer, Valve
- 1-FG-452* Insert, Valve
- 101F864** Insert, Valve
- FG-206-H Valve
- 101F862 Valve
- FG-39-H Seat, Valve
- F-993 Seat, Valve

Note: 8 Valves Req'd. Per Pump

*For polyurethane inserts, order 140F838 insert or 141F706 assembly.

**For polyurethane inserts, order 140F839 insert or 141F743 assembly.

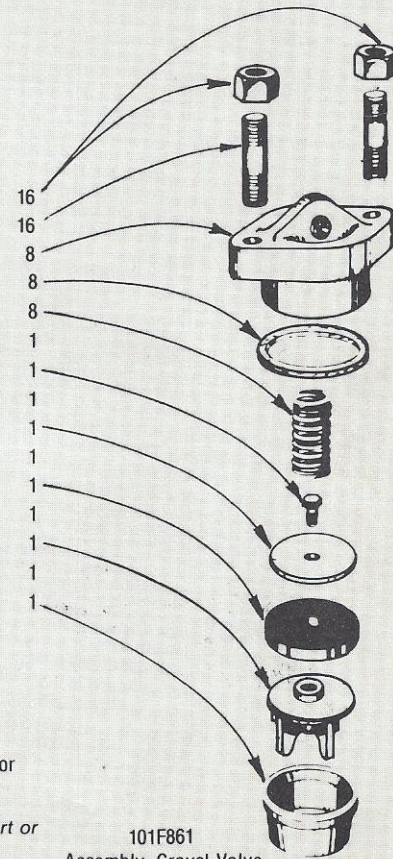

101F861
 Assembly, Gravel Valve