

Twin Disc Mechanical Clutch Parts

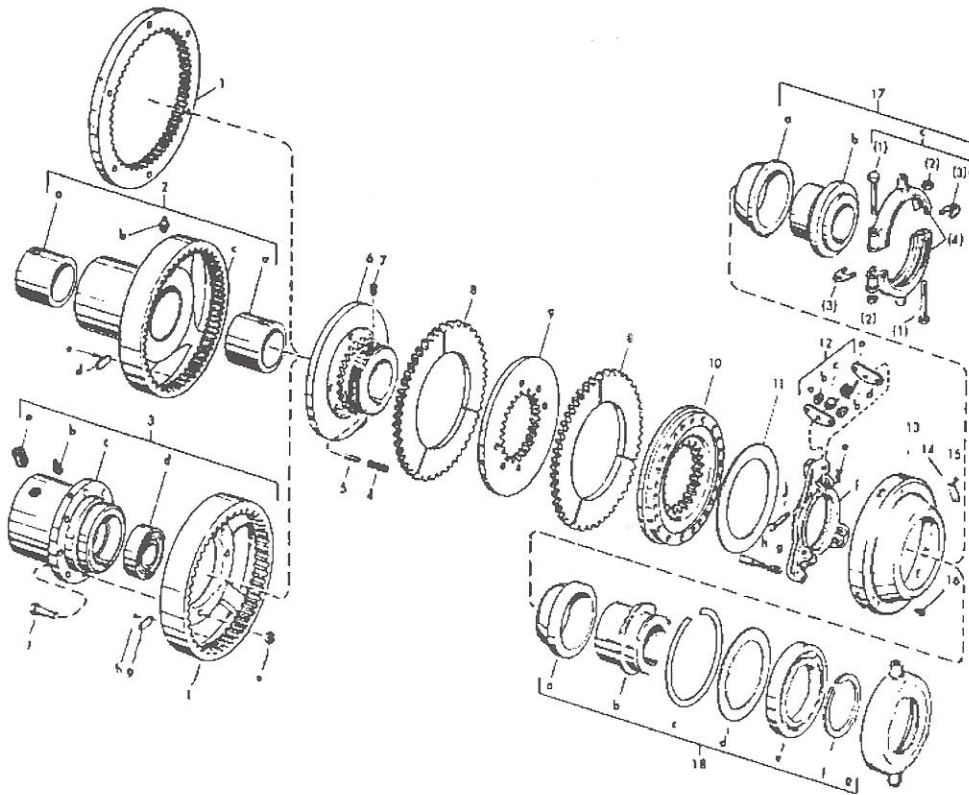

KWIK KLAMP

For Well Drillers, Pump Installers and Well Servicemen

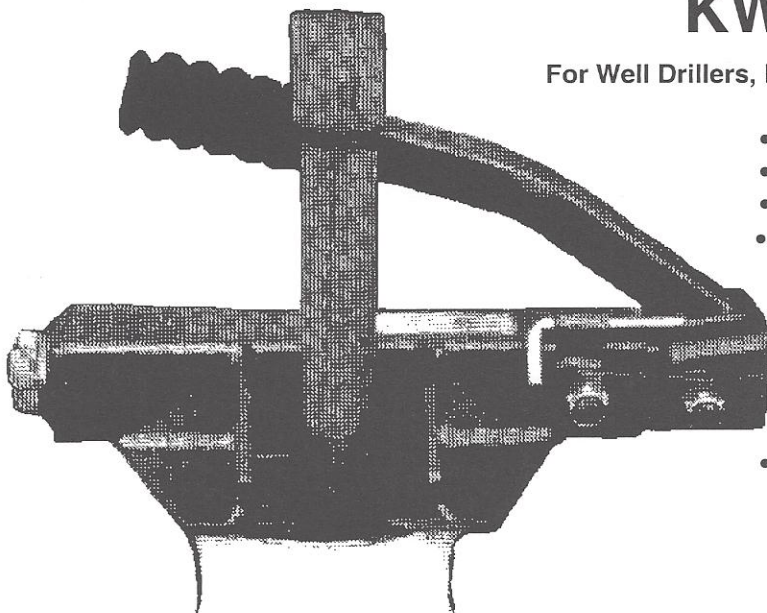

- All Steel Construction.
- Weight: 12 lbs.
- 5" Wide, 12" Long.
- Hold 1" - 2" Galvanized and Plastic Pipe.
 - Load tested over 4,000 lbs.
 - Wide base for more stable holding on large casing.
- All adjustments made by 1" sq. thread shaft hidden in front jaw away from water and dirt.
- Serrated jaws made of high carbon tempered steel and replaceable.

KWIK KLAMP 2

Designed to hold pipe sizes

2" • 2-1/2" • 3" • 4"

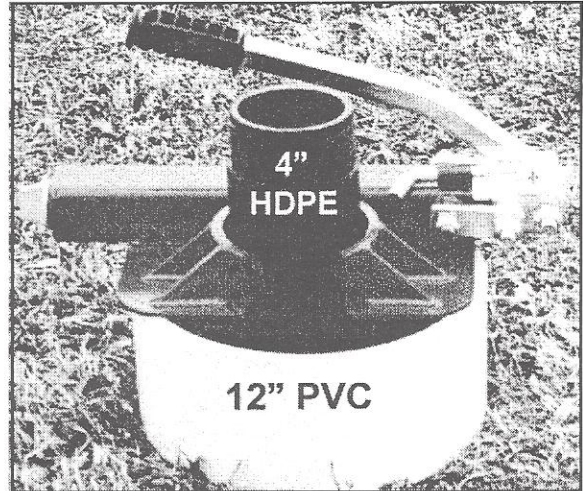
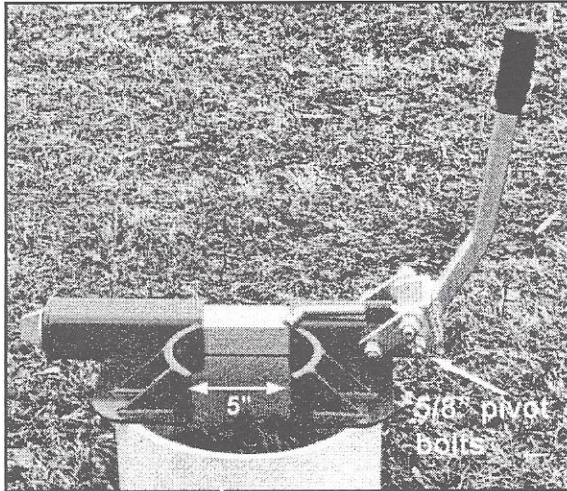

The all new heavy duty **KWIK KLAMP2** is the drillers' answer for holding the larger pipe sizes 2-1/2", 3" and 4". **KWIK KLAMP2** is basically an enlarged version of our popular **KWIK KLAMP** for pipe sizes 1" through 2" with many of the same features.

The tool has been used world wide by environmental drillers, pump installers, well servicemen and water well drillers.

- Main body is constructed of 2" and 2-1/2" 1/4" wall steel tube.
- Easy to operate, working on over center locking when downward pressure is applied to a 19" lever handle.
- 1/2" Safety pin used to prevent accidental unclamping.
- **Kwik Klamp2** allows workers to bring pipe or drill joint up to an easy working level.
- The tool weighs only 30 lbs. and is 20" long x 7-1/2" wide.
- Jaws are equipped with 16 carbide tipped grippers.
- Excellent holding capability with load tests done over 7,000 lbs.
- Designed to hold pipes 2", 2-1/2", 3" and 4" PVC, HDPE, Stainless Steel and galvanized steel.
- **KWIK KLAMP** is one of the safest time-saving tools you will ever own.

