

# SAND GUZZLER

Mix & Match parts to suit your needs.

## How to specify:

Pump Size		
T06	6" Impeller x 2-1/2" FPT	
T09	9" Impeller x 3" Cam Lock 350 gpm	
T11	11" Impeller x 4" Cam Lock 500 gpm	

Housing	
CI	Cast Iron
AL	Aluminum
PH	Poly
RK	Rebuild Kit w/out Motor & Housing
RM	Rebuild Kit w/Motor does not include Housing

Impeller	
C	Cast Iron
A	Aluminum
P	Poly

Impeller	
HP	High Pressure (Poly Only)
SP	Standard Pressure

### Sand Guzzler Specifications:

Mud 0-500 gpm

Hydraulic Oil 10-20 gpm @ 2000 psi

\*All Sand Guzzler pumps come with the Parker Hydraulic Motor:  
Tibban Part# SG001001 Max RPM 3000 Max PSI 3000



### Impeller Options:

**Aluminum:** Good for clear water only; abrasion will wear quickly.

**Cast Iron:** Will last 2-3 times longer than aluminum; can be used with all drilling muds.

**Poly:** Will last 2-3 times longer than the cast iron; can be used with all types of drilling fluid.



### Housing Options:

**Aluminum:** Weighs less than the cast iron  
**Cast Iron:** Weighs more than the aluminum but will last 2-3 times longer

**Poly:** Weight is minimal and although more expensive it will be cost effective because of longevity. Weighs less than the aluminum housing.

## Flow Rates:

### T11 Sand Guzzler 500 GPM

Hydraulic GPM	5	6	7	8	9	9.25	10
<b>11" Standard Impeller</b>							
Hydraulic PSI	1030	1280	1720	2210	2660	2940	
<del>Discharge PSI</del>	4	7	9	13	16	19	
Water Capacity GPM	321	366	442	508	566	582	
<b>11" High Pressure Impeller</b>							
Hydraulic PSI	1535	2070	2550	2570			2900
<del>Discharge PSI</del>	15	20	23	23			25
Water Capacity GPM	432	517	582	591			612

### T09 Sand Guzzler 350 GPM

Hydraulic GPM	5	7	8	9	10	11	12	12.5
<b>9" Standard Impeller</b>								
Hydraulic PSI	560	960	1290	1615	1930	2460	2550	2840
Feet of Head	0.2	8	13	17	22	30	32	36
Water Capacity GPM	210	294	302	395	435	476	492	513
<b>9" High Pressure Impeller</b>								
Hydraulic PSI	630	1040	1340	1660	2100	2330	2680	2860
Feet of Head	6	10	15	21	27	32	39	46
Water Capacity GPM	236	324	370	411	455	472	496	488

\* All values are with the pump submerged in a constant 24" of clear water and measured at the pump & motor nearest points.

# T11 Sand Guzzler Exploded View

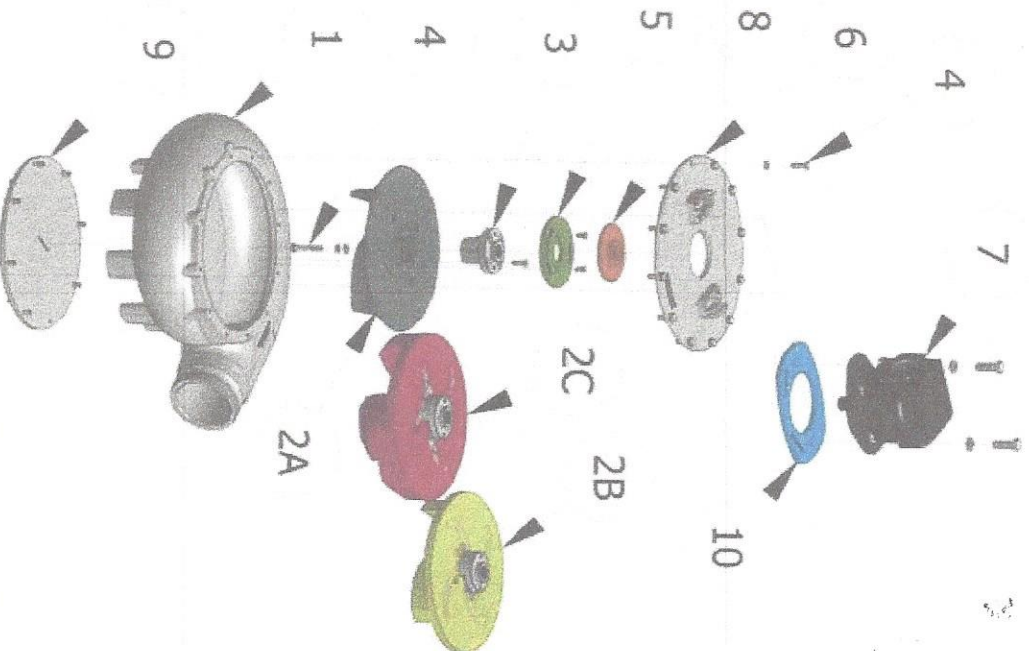
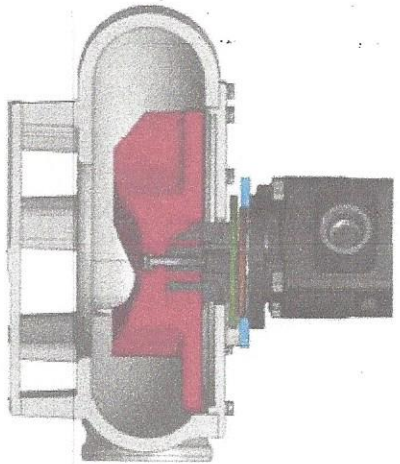
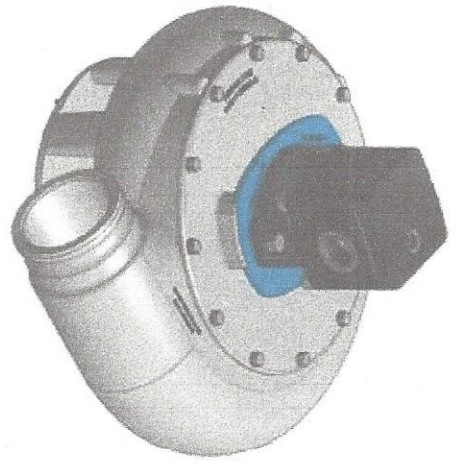

Item	Qty	Part Number	Description	Material
<b>T11 Tibban Sand Guzzler</b>				
<b>Standard Pump Selection</b>				
4	1	T11-8K	Bolt Kit	Steel
5	1	SG00022	Sand Guzzler Splasher Plate	Steel
7	1	SG001001	Pick Up Pump Parker Motor	Varies
8	1	MP12613-2	Hub Spacer	Steel
9	1	SG09-30004	Base Plate	Aluminum
10	1	SG-20003-1	Sand Guzzler Motor Mount Plate	Aluminum
<b>Housing Selection</b>				
<b>Aluminum Option - Good for clear water only; abrasion will wear quickly</b>				
1	1	T11-01-G1-AL	Housing	Aluminum
<b>Cast Iron Option - Weighs more than aluminum but lasts 2-3 times longer</b>				
1	1	T11-01-G1-CI	Housing	Cast Iron
<b>Polyurethane Option - Lasts 2-3 times longer than cast iron and weighs less than aluminum</b>				
1	1	SG11-30002	Housing	Polyurethane
<b>Impeller and Top Plate Selection</b>				
<b>Aluminum Option - Weighs less than cast iron and less durable</b>				
2A	1	T11-02-G1-AL	Impeller	Aluminum
6	1	T11-03-G1-AL	Top Plate	Aluminum
3	1	T11-16-6-1	Splined Hub	Steel
<b>Cast Iron Option - Lasts 2-3 times longer than aluminum; can be used with all drilling muds; cost effective but weighs more than aluminum</b>				
2A	1	T11-02-G1-CI	Impeller	Cast Iron
6	1	SG11-2003-CI	Top Plate	Cast Iron
3	1	T11-16-6-1	Splined Hub	Steel
<b>Polyurethane Standard Pressure Option - Weighs less than aluminum and cast iron and lasts 2-3 times longer than aluminum</b>				
2B	1	T11-02-P	Standard Pressure Impeller	Polyurethane
2C	1	MP201004	High Pressure Impeller	Polyurethane

N.D.S. Drilling Supply  
 26041 Newton Circle  
 Elkton, MN 55020  
 Phone #952-461-3400  
 Fax # 952-461-3403

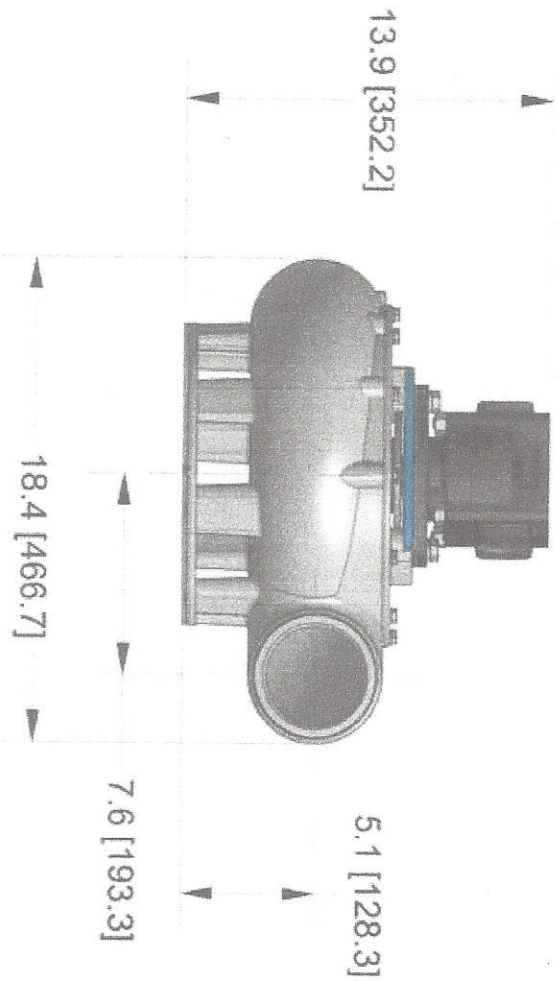
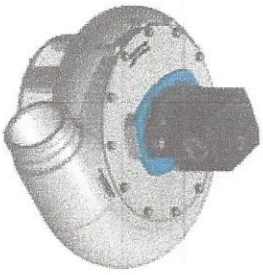
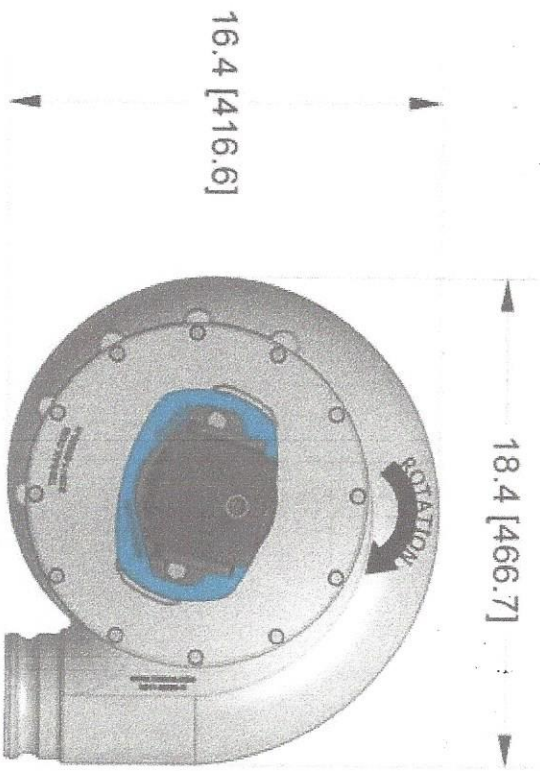

## T11 Sand Guzzler Dimensions

N.D.S. Drilling Supply  
 28041 Newton Circle  
 Elk, MN 55020  
 Phone 888-2-461-3400  
 Fax 888-461-3403